



JET3

MSJET3



ENGLISH USER MANUAL

ORIGINAL INSTRUCTIONS

CAUTION: READ THE INSTRUCTIONS BEFORE USING THE MACHINE



CONTENTS

Introduction	2 - 3	Pump Switch	25
Technical Information	4 - 5	Preparing Cleaning Solution	25
Safety Basics	6 - 7	How to Prime The Pump	26 - 27
Know Your Equipment	8 - 9	Brush Holder & Brushes/Pads	28
Quick Start Guide	10 - 11	Changing JET3 Brushes	29
Where To Use JET3	12 - 13	Brushes/Pads and Applications	30
Storing and Transporting Your JET3	14 - 15	Brush/Pad Cleaning	31
Maintaining Correct Posture	16 - 17	Cleaning With JET3	32 - 33
Adjusting The Handle	18	Targeted Spray Scrub Technology	34
PPE When Using JET3	19	Underwater Use	35
Battery Safety and Information	20 - 21	Product Faults	36
Charging Your JET3 Battery	22 - 23	Your Remote Support Team	37
Electrical Connection	24	JET3 & Backpack Assembly	38 - 39
Water Connection	24	Declaration of Conformity	40
		Your Warranty	41

**YOU MUST REGISTER YOUR MACHINE
TO ACTIVATE YOUR 3 YEAR WARRANTY**

Register your warranty at:
motorscrubberclean.com/warranty

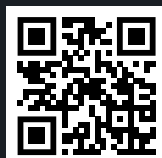

EVERY BUILDING NEEDS A JET3. THIS IS YOURS.

We hope you experience exceptional results with your JET3 machine. If you have any feedback, or need additional support, you can contact the MotorScrubber team at motorscrubberclean.com/support.

ABOUT THIS MANUAL

This manual contains all the information you need to get started with JET3. Please read these instructions carefully.



CAUTION: This machine is for indoor use only

Technical Information



Boasting all the features of the M3, with added spray function. The JET3 completely removes the need for a bucket with chemical. Designed to deep clean and polish any area, achieving like new results.

JET3 is intended for commercial use only. For example in hotels, schools, hospitals, factories, offices, shops and rental businesses.

Our manual has been designed to help you safely and effectively get started with JET3. It includes technical instructions and guidance on how to set up and operate your machine, in addition to storage and maintenance.

We've used symbols throughout our manual to draw your attention to important safety guidance, features and information. Here is an overview of what each symbol means.

PRODUCT LABEL EXPLANATION

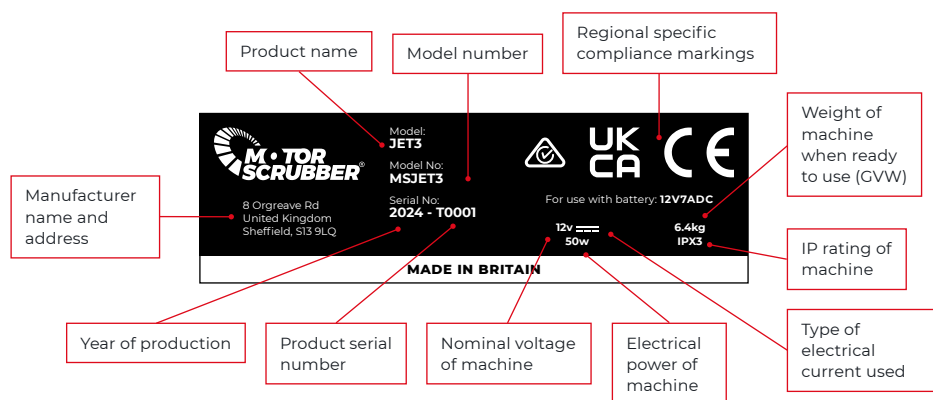

WARNING SYMBOLS



DANGER: Indicates an imminent dangerous situation that, unless avoided, will result in death or serious injuries



WARNING: Indicates a potentially dangerous situation that, unless avoided, could cause death or serious injury



CAUTION: Indicates a potentially dangerous situation that, unless avoided, could cause slight or moderate injuries



Information: Indicates additional information for the operator, to improve the use of the device

OTHER SYMBOLS



Open book symbol with an "i": Indicates the need to consult the instruction manual



Open book symbol: Tells the operator to read the user manual before using the device



Wear Safety Footwear: To signify that safety footwear must be worn



Wear Protective Gloves: To signify that protective gloves must be worn



Wear Eye Protection: To signify that eye protection must be worn



Disposal Symbol: Information regarding the correct means for disposing the appliance



International Recycling Symbol



Ventilation: Specific function should only be performed in a well-ventilated environment



For Indoor Use Only: To identify electrical equipment designed primarily for indoor use



Disconnect Power: Disconnect the power between the battery and the cleaning head

Safety

Basics

JET3 is incredibly safe and easy to use. However, as it is an electrical product we need to make you aware of some important safety information.

By following the advice on this page, you can reduce any risk of electric shock and personal injury.



DANGER: Do not operate in the presence of explosives, or flammable fumes or liquids. Ensure any chemicals you use are non-flammable



DANGER: JET3 is powered by DC current only. Do not attempt to operate JET3 with AC current



DANGER: Never attempt to operate JET3 from an electrical outlet. It should only be powered by the 12-volt battery



DANGER: Consider your work area environment. When using JET3 be aware of overhead electrical wires



WARNING: When changing accessories or undertaking maintenance on JET3, you should always disconnect the machine from the battery



CAUTION: JET3 is a power tool. Although it is safe to operate with one hand during operation, you should operate with both hands when switching the machine on and off



WARNING: JET3's backpack contains magnets. Do not wear or operate the battery backpack if you have a medically implanted device



JET3 is designed to be used by experienced and knowledgeable cleaning professionals over the age of 18. It must not be used by children or anyone with a physical, mental or sensory impairment which could make using JET3 unsafe



Your MotorScrubber JET3 must be kept clean to ensure safe operation. The upper handle and switch area should be dry, and the machine should be clean and free from oil, grease and water when not in use. Always flush out chemical with clean water after every use



Always follow instructions for attaching accessories.
(For Brush Holder see page **30-31**)



Keep product cords and wires away from heat, oil and sharp edges



Ensure you adopt the correct posture when using JET3. Adjust the position of the handle (see page **18**) so your arm is straight, allowing you to maintain a straight back



WARNING: All operators should be adequately instructed on the use of this machine

Know Your Equipment



JET3

1. Control Handle
2. Brush Switch
3. Pump Switch
4. Water Pipe and Connector
5. Handle Length Adjustment
6. Motorhead Complete
7. Spray Nozzle
8. Hub Dark Grey
9. Locking Knob
10. Acorn Nut
11. Thumb Screws
12. Aluminium Tube



BACKPACK

1. Carry Handle
2. 3 Pin Connector
3. Cable Tidy and Holster
4. Battery Pack

BACKPACK: The backpack should be put over your shoulders like a backpack. There are two adjustable straps, which can be pulled to tighten the shoulder supports to a comfortable user level. Ensure the hook and loop belt strap is fastened across your abdomen.

ACCESSORIES

5. Green Scrubbing Pad
6. White Buffing Pad
7. Microfibre Pad
8. Red Polishing Pad
9. Medium Dry Brush
10. Charger



WARNING: Always inspect JET3 for damage before use



WARNING: JET3's backpack contains magnets. Do not wear or operate the battery backpack if you have a medically implanted device.



Charge battery (page **22-23**)



Put on the backpack



Adjust straps



Fill bottle (page **25**)



Attach/remove Brush Holder and add/
change JET3 pad (page **30-31**)



Connect electrics (page **24**)



Prime the pump (page **26-27**)



Connect water (page **24**)



Adjust handle length (page **18**)



Clean with JET3 (page **32-33**)

Where to use **JET3**



Kitchen Cleaning



Walls



Stairs



Floor Cleaning



Swimming Pools



Textured Surfaces

Storing and Transporting

Your JET3

JET3 has been designed to be safe and easy to transport when following the below safety advice.

MACHINE TRANSPORTATION

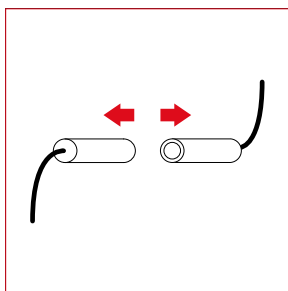

Disconnect the power
connection between the
battery and the JET3 (see
page **22-24**)



CAUTION: Secure the machine when transporting in a vehicle to prevent damage to the machine

JET3's compact design means that it is easy to store. We recommend using a wall dock or M-CASE for proper storage. However you choose to store your JET3, you should follow the below guidance.

MACHINE STORAGE

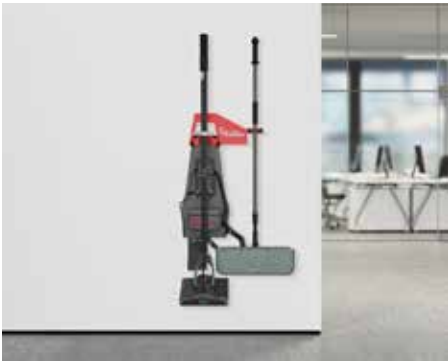

 WALL DOCK



 M-CASE PRO



If the appliance is to be stored unused for a long period, the battery backpack should be disconnected from the machine via the cable connector. Alternatively, the battery can be removed from the backpack



WARNING: When storing or carrying batteries, always ensure that they cannot come into contact with any metal objects. This could result in the battery short circuiting, causing fire, personal injury or damage to the battery



WARNING: The battery and charger must never be used or stored in outdoor environments, or in damp conditions



CAUTION: This machine should be stored indoors only

Maintaining Correct Posture





According to a joint study by UNISON and the Health and Safety Executive, 20% of cleaners using floor cleaning machines need time off work because of aches and pains. We've designed our GEN3 Battery Backpack and JET3 to be ergonomic and easy to use, reducing the risk of strains and injury.

Your backpack should be correctly worn and adjusted before using your machine. Each time you wear the backpack you should adjust the shoulder straps and secure the waistband.

Ensure you adopt the correct posture when using JET3 and maintain a straight back.

Adjust the position of the control handle so your arm is straight when holding the handle. Your back should be straight at all times.

RULES TO FOLLOW

- Your backpack should be correctly worn and adjusted before using your machine
- Each time you wear the backpack you should adjust the shoulder straps and secure the waistband
- Ensure you adopt the correct posture with a straight back when using JET3. Let JET3 do all the work

Adjusting the Handle



ADJUSTING THE HANDLE LENGTH

Release the black clip by pushing up the release catch. (1) Adjust the pole to your desired length, then push the black clip back into position. Do not extend further than the red stop line printed on the handle.

If the telescopic pole is slipping while in use, you will need to ensure the clip

is tightened appropriately. To do this, locate the green adjustment screw (2) and ensure the black clip is in an open position.

Being careful not to over tighten, turn the screw clockwise (3) until you can comfortably push the black clip back into its lock position. If the black clip

is difficult to push back, turn the green screw anti-clockwise until it is easy to push back into position. For an instructional video please visit: www.motorscrubberclean.com/support

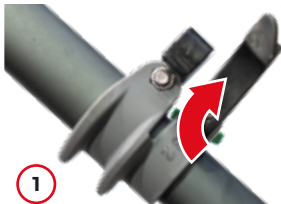

HANDLE POSITION

The Control handle is pre set to the optimum position and we don't recommend changing this. However, if you do wish to change the handle position it can be done by following these simple steps.

1. Turn the JET3 over so the back of the handle is facing you.
2. Using a Phillips screwdriver, remove the two screws and take off the handle base.
3. Move the handle to your desired position, replace the handle base and screws.



PPE when using JET3

GENERAL USAGE

When operating JET3 you should always wear safety footwear, which is well gripped. If you're cleaning with water only, no additional PPE is required. However, if you're using disinfectant or chemical, you should always follow the manufacturer's PPE advice.



Wear safety footwear whilst operating and servicing JET3

USING SPRAYS AND CHEMICALS

For more information on using chemicals with JET3, see page **25**.

As with all spraying equipment, it is possible that some of the smaller droplets will be inhaled by the user, which could be dangerous for prolonged periods of time.

Please check your chemical's MSDS sheet, which will give clear instructions of PPE required when using their product.

If unsure, contact your chemical manufacturer. Explain how many hours of usage you will be using the product for. They can then recommend what PPE to wear to protect yourself.

Always flush out chemical with clean water after every use. If chemical is left to sit in the pump and pipe work it can dry and jam the pump, or clog the pipes.





Ensure that you follow your chemical manufacturers advice on the need for additional PPE, such as protective gloves and eye protection

Battery safety and information

JET3 is powered by either a 12-volt sealed lead acid battery OR a 12 volt Lithium Ion Battery. More information on the battery run time and charging can be found on page **22-23**.

Only use the battery charger provided with your JET3 to ensure it is charged safely.

BATTERY	CHARGER	LABEL COLOURS
Lead Acid Battery (12V7ADC)	MS1580 (A, B, C)	
Lithium Ion Battery (12V18ADC)	MSCHARGLITH (6AMP)	

Operating the machine on an empty battery could cause permanent damage to it. Charge or swap batteries as soon as the 'low warning' battery indicator (shown below) is illuminated.

We recommend having spare batteries to hand.



DANGER: Do not disassemble, heat above 122°F (50°C), or incinerate the battery.
Risk of fire, explosion, or burns



WARNING: Never attempt to open a battery for any reason. If the housing of the battery breaks or cracks, immediately discontinue use and do not recharge. The battery should be replaced



WARNING: Do not charge a battery if it is wet or shows any evidence of corrosion



WARNING: Do not incinerate the battery; it can explode in a fire



WARNING: Plug the battery charger directly into a 120VAC/60HZ or 240VAC, with the correct plug adaptor, electrical outlet (Do not use an extension cord)



CAUTION: In the unlikely event of battery leakage, wash eyes and skin with water if contact is made with acid and seek medical advice immediately.

BATTERY HANDLING

If it is suspected that free electrolyte is present, then safety glasses must be worn, and if large amounts are present, chemical goggles or face shield should be used.



WARNING: Harmful if swallowed



WARNING: Keep out of the reach of children



WARNING: Don't immerse, throw, wet the battery in water



WARNING: Don't short circuit (+) and (-) terminals with metallic object intentionally



CAUTION: If it is suspected that free electrolyte is present, then safety glasses must be worn, and if large amounts are present, chemical goggles or a face shield should be used.



CAUTION: Remove ALL metallic objects from the person when working with batteries. This includes jewellery (rings, bracelets, necklaces), watches, pens, torches, etc. Don't store the battery in a pocket or a bag together with metallic objects.



CAUTION: Where there are signs of damage or liquid (electrolyte) or solid deposits, rubber gloves and acid resistant clothing must be worn when handling the batteries and affected packaging to protect against the effects of any electrolyte that may be present



FUSE PROTECTION: JET3 is equipped with a 15 AMP replaceable fuse to protect against short circuit. This fuse can be found inside the battery compartment



The green wire used within this system is a low voltage power return from the pump switch

Important Information

CHARGING YOUR JET3 BATTERY

Your JET3 battery (12V7ADC) is a rechargeable sealed lead-acid battery (VRLA). It can be charged two ways:

In-backpack

Connect your battery (12V7ADC) to your charger MS1580 (A, B, C) whilst fitted into your backpack using the charging port on the left side of the battery compartment.



If you have 2 pin-connector charger

As a spare battery

Connect your battery (12V7ADC) to your charger MS1580 (A, B, C) using the charger adapter (MSS228).



Connect your battery (12V7ADC) to your charger MS1580 (A, B, C) whilst fitted into your backpack using the 3-pin coiled cable (MS3009D) on the right side of the battery compartment.



If you have 3 pin-connector charger

Connect your battery (12V7ADC) to your charger MS1580 (A, B, C) using the charger adapter (MSS228B-3PIN).



Always plug your charger directly into a 120 VAC/60HZ or 240 VAC electrical outlet, or use an adapter or charger for the AC source being used (do not use an extension).



WARNING: Only use the supply unit (MS1580, MLF-012W1201000) provided with this appliance to charge the battery (12V7ADC)



WARNING: Do not charge VRLA Batteries above + 50 °C, discharge or store above + 60 °C

For best results, do not charge a battery when the battery or air temperature is below 40°F (5°C) or above 105°F (40°C). When charging the machine the red light will show, when the battery is fully charged the light will show green.

After charging, disconnect the charger from the AC outlet and (IMPORTANT) disconnect the charger from the battery.



CHARGING



CHARGED



ATTENTION: The space used for charging the battery must be adequately ventilated

Important Information

CHARGING YOUR JET3 LITHIUM BATTERY 12V18ADC

Your JET3 battery 12V18ADC is a rechargeable Lithium Ion Battery. It can be charged two ways:

In-backpack

Connect your battery (12V18ADC) to your charger MSCHARGLITH (6AMP) whilst fitted into your backpack using the charging jack on the wiring harness on the top of your battery.

As a spare battery

Connect your battery (12V18ADC) to your charger MSCHARGLITH (6AMP) using the charging jack on the wiring harness on the top of your battery.

Always plug your charger directly into a 120 VAC/60HZ or 240 VAC electrical outlet, or use an adapter or charger for the AC source being used (do not use an extension).

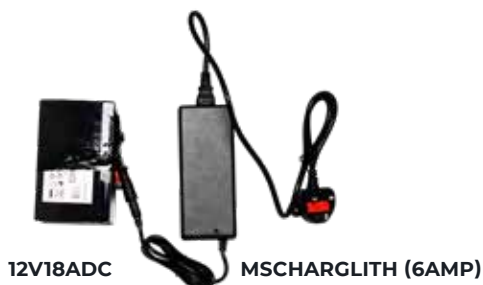

BATTERY PERFORMANCE

Batteries should be charged **before using your JET3**, after each use and if unused for four months.

Battery Type	A full charge from flat	Run Time (full charge)
Lead Acid Battery (12V7ADC)	Approx 4 hours	Approx 3.5 hours
Lithium Ion Battery (12V18ADC)	Approx 3 hours	Approx 8 hours

* Different floor and pad types may reduce run time.

If you require long periods of machine use, we recommend you also order spare batteries. When ordering 12V18ADC as a spare battery, you should also order the MSCHARGLITH (6AMP) charger.

When ordering 12V7ADC as a spare battery, you should also order the MSS228 charging adapter and MS1580 (A, B, C) charger.

Important Information

ELECTRICAL CONNECTION

The machine connects to the backpack using a quick fit stainless steel electrical connection. Simply line up the red dots and push until you hear a click. To release the connection, grip the textured areas and pull apart.



CAUTION: Before you connect the power cable, check the machine is not on. The red switch operates the brush head. This is a latching switch, depress the switch until you hear a click and let go, the motor will run continuously. Press again and this will stop the brush. It is important that this button is not depressed before you connect the electrics



WATER CONNECTION

Firstly, make sure the connector is facing the right way. The white collar of the connector should point towards the machine and flow of water. Push the water pipe into the connector until the pipe stops. This is roughly 7mm. To separate the connection, with a finger on either side of the waterpipe, push down on the white collar towards the black housing and pull the pipe out.



PUMP SWITCH

The upper blue switch operates the pump which powers the spray. This is a demand switch and needs to be held down to operate the pump. When the button is released, the pump will switch off and the spray will stop.



PUMP



OSCILLATING FLOOR PAD

PREPARING CLEANING SOLUTION

JET3's powerful agitation and latest pad technology will clean floors using just water. Some cleaning challenges may require chemical. For example use a degreaser for removing grease or oil, and use a descaler for removing scale build up in bathrooms and pool areas.

Fill the bottle with your preferred cleaning solution up to the neck of the bottle. Screw the cap into place, being careful not to cross thread it. Slip the bottle into the pouch on the harness.



It is very difficult for us to approve every chemical on the market, however the majority of cleaning detergents are safe to use with your MotorScrubber backpack. If you do use some very harsh chemicals, it is possible that the life expectancy of some components will be reduced, such as the pump membrane, check valve and water-pipe. These components are all replaceable at affordable costs. Using some harsh chemicals may result in more frequent servicing.



WARNING: Ensure current regulations concerning safe transportation of dangerous substances are followed



WARNING: Do not use flammable chemicals or solutions

Important Information

HOW TO PRIME THE PUMP

Every MotorScrubber machine is thoroughly tested in our factory before dispatch. It is possible during storage and transportation for an airlock to develop in the pumping system. To release any airlocks present, you can follow the priming steps below before use. The initial prime takes roughly two minutes to complete.

1. Put the backpack on.
2. Fill the bottle with clean water and insert the water pipe with the filter, but leave the cap off loose.
3. Connect the electrical connection on the machine.
4. Disconnect the backpack water pipe from the black check valve and insert this into the top of the bottle, this will re-circulate the fluid.
5. Hold down the blue switch until fluid starts flowing. The pump will go through the following stages:
 - **Air** - Trapped air starts to work through the system. High pitch pump noise with drips from the pipe.
 - **Water** - The pump will start to take water into the system. Pump noise deepens with weak spray from the pipe.
 - **Primed** - The pump will make a deep continuous hum, you will see high pressure water coming from the water pipe.
6. When you request water, it should be an instant start / stop of water flow with a constant high pressure flow.

The first prime can take up to two minutes to complete. Further primes will take approximately 30 seconds using this method. A prime will need to be carried out before each use.

This process should also be used to rinse out chemical after every use.



HOW TO PRIME THE PUMP

If you're still not sure how to complete this process, scan this code to watch an instructional video.



Important Information

BRUSH HOLDER AND BRUSHES/PADS

The JET3 is compatible with a wide range of pads and brushes, designed for a wide variety of uses. These additions are attached and removed with a simple rotating lock system. Please follow the step-by-step guide. To ensure optimum cleaning performance, we advise following these guidelines:

- Ensure the brush or pad is perfectly flat against the floor for smooth machine operation and optimal cleaning.
- The JET3 is designed for low water usage, requiring only a small amount of detergent. Its 1L / 0.21 gal solution capacity can effectively clean up to 40m² / 430ft². Let the brush and powerful scrubbing action efficiently lift dirt.
- Avoid using water hotter than 35°C (95°F) to prevent damage to valves and pumps.
- When the solution bottle is nearly empty, indicated by the jet spray finishing, refrain from operating the pump to avoid airlock. Simply refill with chemical and prime the pump.
- Post-use, it's crucial to flush the pumping system to prevent damage or clogging from residual chemicals. Fill the bottle with clean water and activate the blue switch for 60 seconds until the output changes from foam to clear water.
- While most cleaning detergents are compatible with JET3, using harsh

chemicals may require more frequent servicing as they can reduce the lifespan of components like the pump membrane, check valve, and water-pipe. These parts are replaceable at a reasonable cost.

- For scrubbing, use straight, light strokes. Apply mild pressure as needed and allow JET3 do the hard work for you.



WARNING: ALWAYS disconnect the power between the backpack and JET3 before adding or removing the Brush Holder or cleaning brushes & pads



WARNING: Ensure fingers are kept clear of JET3's rotating mechanism



WARNING: Only use cleaning pads which have been specifically designed and recommended for the JET3. We cannot guarantee the safety of any other cleaning brushes or pads

CHANGING JET3 BRUSHES

1. Turn the MotorScrubber upside down and support the handle with the inside of your foot.
2. Line-up the tabs on the disc with the hub on the MotorScrubber.
3. Hold the hub firmly to prevent rotation. Press down while turning the disc clockwise until it locks in place.
4. To remove, press down on the disc and turn it counter clockwise holding hub until tabs are free. Then lift off the disc.



REMOVING DIRTY SLURRY

There are many ways to remove dirty slurry after cleaning, the most effective ways are:

1. MotorScrubber can be equipped with a suction head, which can be connected to a wet vac for instant slurry pickup.
2. Squeegee - Many hard floor areas have a drain in the floor. Dry and remove the slurry with your Blade floor squeegee into the drain.
3. Attach BLADE A-Fibre and dry.



A-Fibre

- Absorbs 500ml/0.13ga of liquid.
- Absorb Spills & Dry Floors.

Brushes/Pads and Applications

JET3 is supplied with five pads/brushes, each with specific features and applications.



MEDIUM DUTY BRUSH

Non scratch fibres provide a brilliant deep clean to all smooth and textured floors and tiles

Application: Versatile pad suitable for cleaning all floor types.

Reusable: This pad should last three to six months.



GREEN SCRUBBING PAD

For cleaning greasy kitchens and floors. This pad aggressively removes dirt from heavily soiled surfaces

Application: For daily maintenance on most floor types between deep cleans

Reusable: Wash up to 300 times



WHITE BUFFING PAD

For buffing on hard floors. Use dry or with a fine water mist to give a high gloss wet look to new floors

Application: For daily maintenance on most floor types between deep cleans

Reusable: Wash up to 300 times

BRUSH/PAD CLEANING

1. Remove Brush Holder (See page 29)
2. Remove cleaning brush or pad from the Brush Holder
3. For disposable brushes/pads – dispose in accordance with local environmental regulations
4. Washable brushes/pads can be cleaned using the instructions provided on the pad labelling

MICROFIBRE PAD



Recommended for polishing surfaces and for carpet spot cleaning

Application: Versatile pad suitable for cleaning all floor types.

Reusable: This pad should last three to six months.

RED POLISHING PAD



For polishing hard and wooden floors. This will remove light scuff marks and dirt while giving a high gloss shine

Application: For daily maintenance on most floor types between deep cleans

Reusable: Wash up to 300 times



CAUTION: Only use cleaning brushes & pads which have been specifically designed and recommended for JET3. We cannot guarantee the safety of any other cleaning brushes & pads

Cleaning with JET3

- When using MotorScrubber make sure the brush or pad is flat to the floor, this will ensure smooth operation of the machine and an optimal clean.
- The JET3 is a low water use cleaning machine. Only a small amount of detergent is required to wet and clean the floor, allow the brush and powerful scrubbing action to release the dirt. The 1L / 0.21 gal solution capacity can efficiently clean up to 40m² / 430ft².
- Do not use water hotter than 35°C (95°F), this can damage the valves and pump.
- When the solution bottle is nearly empty, look for the jet to stop spraying.
- Do not operate the pump as this will create an airlock. Simply re-fill with chemical and prime the pump.
- After every use, you need to flush the pumping system. To do this fill the bottle with clean water and hold down the blue switch for 60 seconds. Foam will spray from the jet and you will see this change to clean water. This is a vital step as the valves and small pipes can become damaged or clogged with chemical, if left to sit for a long time. To maintain your warranty this step must be carried out.
- It is very difficult for us to approve every single chemical on the market, the vast majority of cleaning detergents are safe to use with your MotorScrubber backpack. If you do use some very harsh chemicals, it is possible that some components life expectancy will reduce, such as the pump membrane, check valve and water-pipe. These components are all replaceable at affordable costs. Therefore using some harsh chemicals may result in more frequent servicing.

- Scrub with straight, light strokes. You can exert light pressure where needed, let MotorScrubber do the hard work for you.

DO NOT USE MOTORSCRUBBER WITH FLAMMABLE CLEANING FLUIDS

FUSED PROTECTION

MotorScrubber is equipped with 15Amp replaceable fuse, to protect against short circuit. This fuse can be found inside the battery compartment.



SLIP HAZARD: JET3 applies water and/or cleaning solution to the floor, creating a potential slip hazard. Ensure appropriate PPE footwear is worn (See page 19)



SLIP HAZARD: JET3 is intended for commercial use. Ensure others are alerted to the potential slip hazard by using appropriate signage

BUTTON REMINDER

The blue switch operates the pump which powers the spray. This is a demand switch and needs to be held down to operate the pump. When the button is released, the pump will switch off and the spray will stop.



PUMP



ROTATING FLOOR PAD

REMOVING DIRTY SLURRY

There are many ways to remove dirty slurry after cleaning, the most effective ways are:

1. Many hard floor areas have a drain in the floor. Dry and remove the slurry with your BLADE floor squeegee into the drain.
2. Attach BLADE A-Fibre and dry. Each A-Fibre holds 500ml of liquid. Wash A-Fibres after use.





Targeted Spray Scrub Technology

On-board chemical
injection means
**4x faster cleaning
with the JET3.**

**Boasting all the features of the M3,
with added spray function. The JET3
completely removes the need for a
bucket with chemical.**

**Designed to deep clean and polish
any area, achieving like new results.**

Key Benefits:

- Lightweight
- Built-in Spray Function
- Spray on Demand
- Cordless Backpack Technology
- 3.5 - 8 Hour Runtime

3.5 - 8 hour runtime allows the user to clean anywhere. Fully adjustable and lightweight, the padded backpack fits any user.

The JET3 comes with a 1 Litre / 0.21 gal bottle for your solution, which can be easily removed for quick refilling.



Underwater Use

- Because its motor head can be fully-immersed in water, the MotorScrubber is ideal for many underwater cleaning tasks. One of the more popular uses of the MotorScrubber is cleaning the “scum line” above the water level in swimming pools, spas, boats, etc.
- Immersing the head for long periods of time could effect its water-proofing seals, due to the effects of prolonged heating, cooling and chlorine. The seals could contract and allow water to make direct contact with the motor, which would cause a motor failure. Guidelines need to be followed to avoid this.
- If the unit is used underwater on a regular basis, an internal inspection of the head is also required each month by a competent technician, this is to check for water ingress.

WE RECOMMEND NOT USING THE MOTORSCRUBBER FULLY SUBMERGED IN WATER FOR MORE THAN 2 MINUTES CONTINUOUSLY. MOTORSCRUBBER SHOULD THEN BE REMOVED AND ALLOWED TO COOL FOR 5 MINUTES.

- Waterline cleaning, where MotorScrubber is half in and half out of the water there is no limitations.
- Regular underwater usage will reduce the lifetime of the head unit. MSGREY12V complete motor head can be purchased and replaced when required. 1 year is the suggested life of regular underwater use.



Fully submerged Use

for 2 minutes then take out to cool for 5 minutes.

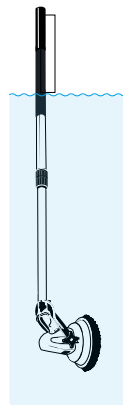

Submerge up to 25cm away from the switches.

Scum line cleaning

There are no limitations, you can clean continuous using this method.

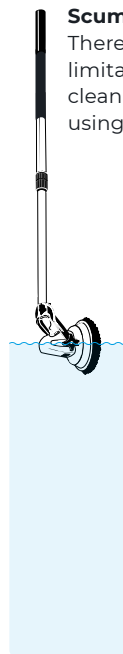

Product Faults

PRODUCT FAULT INDICATION

You should inspect your JET3 for damage before each use. This is especially important if you are using JET3 as part of a larger cleaning team.

If the JET3 battery level indicator has all of its display lights flashing continuously - this could mean that there is an error with the machine. Examples of errors include electronic faults and overheating.

The battery charger supply (type Z connector) cord cannot be replaced. If the cord is damaged, the battery charger should be scrapped. Please contact the manufacturer/distributor for a replacement unit.



ATTENTION: Do not use the JET3 if it appears damaged or faulty



Exhausted batteries are to be removed from the appliance and safely disposed of in an environmentally friendly manner in accordance with local national laws and regulations



YOUR REMOTE SUPPORT TEAM

JET3 is manufactured and assembled at our headquarters in Sheffield, UK, by a team of skilled assembly technicians.

Working closely with our design and engineering team, they know each one of our machines inside out, which means they are best placed to assist you in the rare instance you experience a product fault.

If you need technical support you can contact us at www.motorscrubberclean.com/support.

Our team are typically able to resolve faults remotely, guiding you through undertaking the repairs yourself. Sometimes they may ask you to take a video of your machine's fault so they can be certain they are giving the correct advice.

Please don't void your warranty by attempting to resolve a product fault without proper guidance from one of our technicians. For more information on our warranty, see page 43.



JET3 Assembly

1. **MS3003R** ALUMINIUM TUBE
2. **MS3004C** GRAB HANDLE
3. **MSS103** RUBBER GRIP
4. **J2SUB2E - 3PIN** JET SWITCH HOUSING
5. **MS1041** MEDIUM DUTY BRUSH
6. **MSS172B** THUMB SCREW
7. **MSGREY12V** MOTORHEAD WITH YOKE
8. **MSJ40** JET ARM BRACKET
9. **011 0016** JET NOZZLE CHECK VALVE
10. **MSJ42C** JET NOZZLE
11. **MSS032** HANDLE FLIP CLIP 32MM

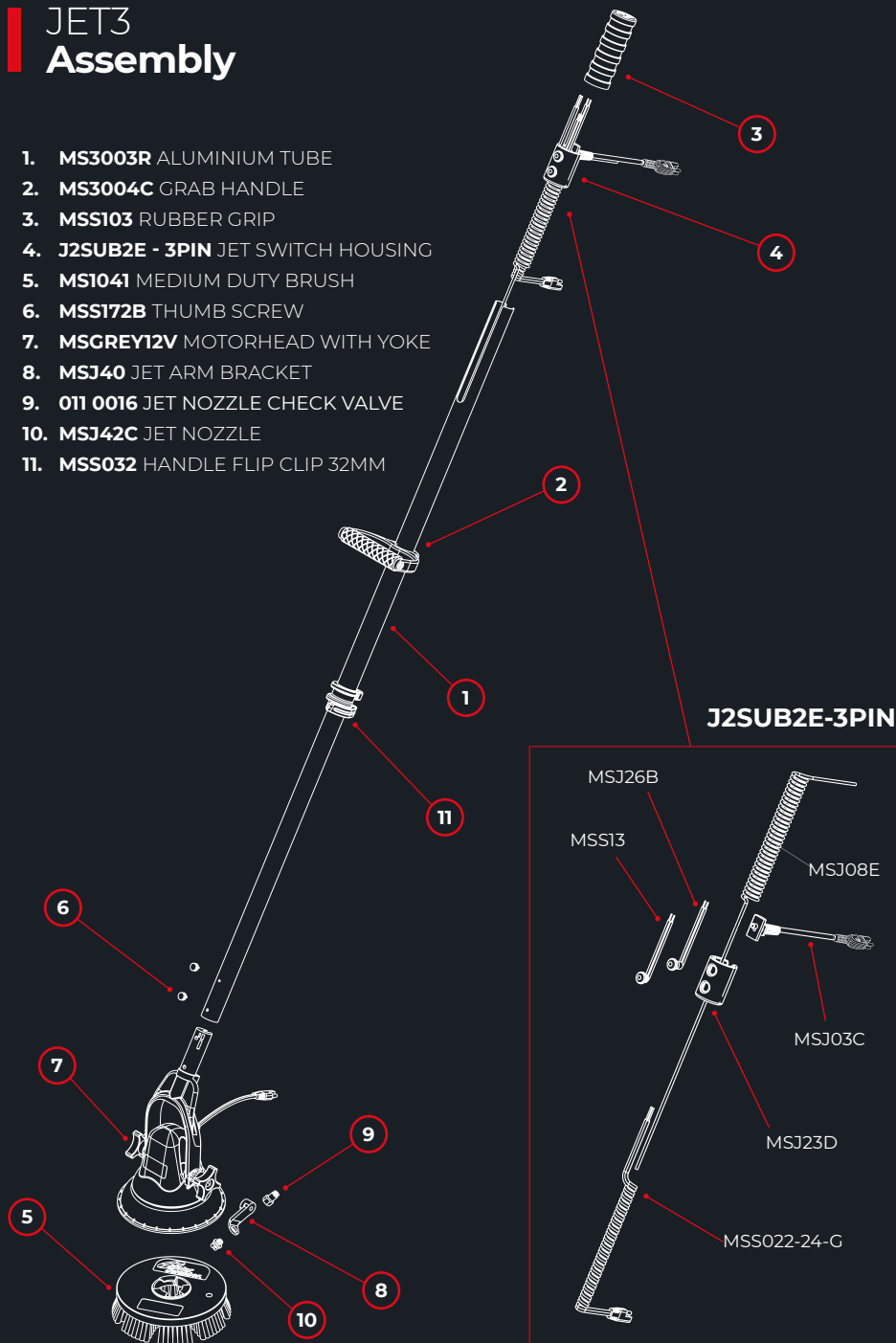

Backpack Assembly

1. **MSS02-B** BACKPACK
2. **MSJ09B** WATER/SOLUTION BOTTLE
3. **MSJ11** IN LINE CHECK VALVE
4. **J1SUB2** JET PUMP ASSEMBLY
5. **12V7ADC/12V18ADC** BATTERY
6. **MSJ08E** COILED WATER PIPE
7. **MSJ02C** 2 CORE COILED PUMP CABLE
8. **MSJ07B** WATER PIPE
9. **MSJ01D-3PIN** 3 CORE COILED CABLE (CHARGING 3-PIN CHARGER)
10. **MSJ15B** HOSE END SUCTION FILTER
11. **MSJ10B** JET BOTTLE CAP
12. **MSJ45** CHARGING CABLE CONNECTION (FOR 2 PIN CHARGERS)
13. **MS1580/MSCHARGELITH (6AMP)** BATTERY CHARGER
14. **MSPAUK/US/AU/EU** REGIONAL SPECIFIC PLUG ADAPTOR FOR CHARGER

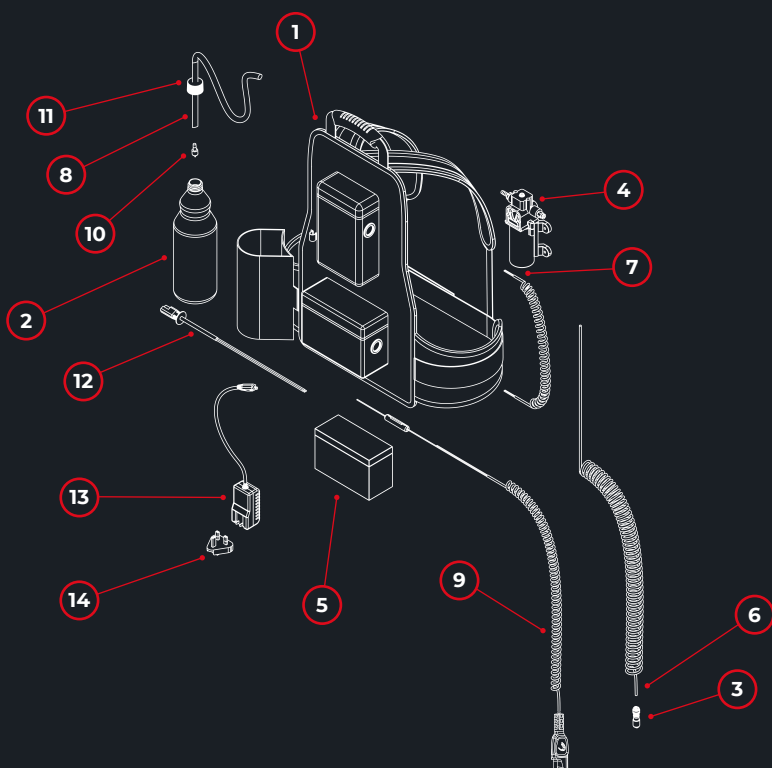



Declaration of Conformity

07/08/2023

The following products have been reviewed by MotorScrubber Ltd and external testing partners to ensure compliance with the applicable directives & standards.

Applicant: MOTORSCRUBBER Limited

Address: 8 Orgreave Road, Sheffield, S13 9LQ, United Kingdom

Product: MotorScrubber Battery Operated Cleaning Machine.

Model no(s): M3S, M3M, M3L, MSJET, MSPROWASH, MSSHOCK, MSSTORM

Rated Input: AC 100 – 240Volt~, 50/60Hz, 0.6Amp

Rated Output: DC 12 Volt, 7Ah

Model No: MSFORCE

Rated Output: DC 24 Volt



Conforms to:

Supply of Machinery (Safety) Regulations 2008
Electrical Equipment (Safety) Regulations 2016
Electromagnetic Compatibility Regulations 2016

Designated Standards

EN60335-1, EN60335-2-72, EN60204,
EN55014-1, EN55014-2

Conforms to:

Machinery Directive 2006/42/EC
Low Voltage Directive 2006/95/EC
EMC Directive 2004/108/EC

Harmonized Standards

EN60335-1, EN60335-2-72, EN60204,
EN55014-1, EN55014-2

The product technical Construction Files are held at the above address, this includes the supplied A.C. Charging Adapter.

Yours Sincerely

Imre Killi – CEO

Signed: *Imre Killi*

Date: *07/08/23*

**TRANSFORM
THE WAY
YOU CLEAN**

HEAD OFFICE

8 Orgreave Rd, Sheffield, S13 9LQ, England
+44 (0)114 478 8710 / orders@motorscrubberclean.com

USA

+1 630 326 3107 / usaorders@motorscrubberclean.com

AUSTRALIA

+61 499 269 988 / aussorders@motorscrubberclean.com



Company Reg: 1027714 / VAT No: 318 1540 39

Your Warranty

LIMITED THREE-YEAR WARRANTY MotorScrubber JET3

ONE YEAR COMMERCIAL WARRANTY AS STANDARD. THREE YEAR COMMERCIAL WARRANTY AFTER REGISTERING YOUR JET3.

JET3 is built to withstand the challenges of commercial cleaning, using high quality components that are tested to their limits. Each machine is assembled and quality inspected at our Sheffield HQ, and no machine passes through our doors without meeting our rigorous standards.

We're so confident in the quality of our products that we offer a three-year commercial warranty on all registered machines**, for complete peace of mind and worry-free cleaning.

If your machine encounters any issues, our helpful team aim to get you back up and running in the shortest possible time.

Most faults can be rectified remotely, so should any problem covered by this warranty develop during the three-year period, please send a photo or video of the fault to warranty@motorscrubberclean.com and our warranty team will guide you in your repair.

If the fault cannot be rectified remotely then follow the instructions in this booklet and return the unit, carefully packaged with freight prepaid to your original supplier.

Your supplier will inspect the item and liaise with us directly. If inspection shows the problem was caused by a defect in workmanship or materials, your supplier will repair (or at our joint option, replace) the unit without charge, return freight prepaid.

PLEASE DON'T VOID YOUR WARRANTY BY:

1. Making alterations to the product.
2. Repairing or attempting to make repairs by anyone other than an authorised MotorScrubber agent, unless guided remotely.
3. Mistreating, misusing or improperly maintaining or operating the product.
4. Using non-genuine floor pads

YOU MUST REGISTER YOUR MACHINE TO ACTIVATE YOUR 3 YEAR WARRANTY

Register your warranty at:
motorscrubberclean.com/warranty



*Terms and conditions may vary depending on your country, please contact your local supplier for exact terms.

**Our standard warranty is 1 year if it isn't registered with us.



**YOU MUST REGISTER
YOUR MACHINE TO
ACTIVATE YOUR
3 YEAR WARRANTY**

Register your warranty at:
motorscrubberclean.com/warranty

HEAD OFFICE

UK

8 Orgreave Rd, Sheffield,
S13 9LQ, England
+44 (0)114 478 8710
orders@motorscrubberclean.com

info@motorscrubberclean.com
www.motorscrubberclean.com

INTERNATIONAL

USA and Canada - Chicago

+1 630 326 3107
usaorders@motorscrubberclean.com

AUSTRALIA - Melbourne

+61 459 269 988
ausorders@motorscrubberclean.com